

Nigel Valley Neighbourhood Plan | Site Analysis

Existing Circulation, Parking and Accessibility

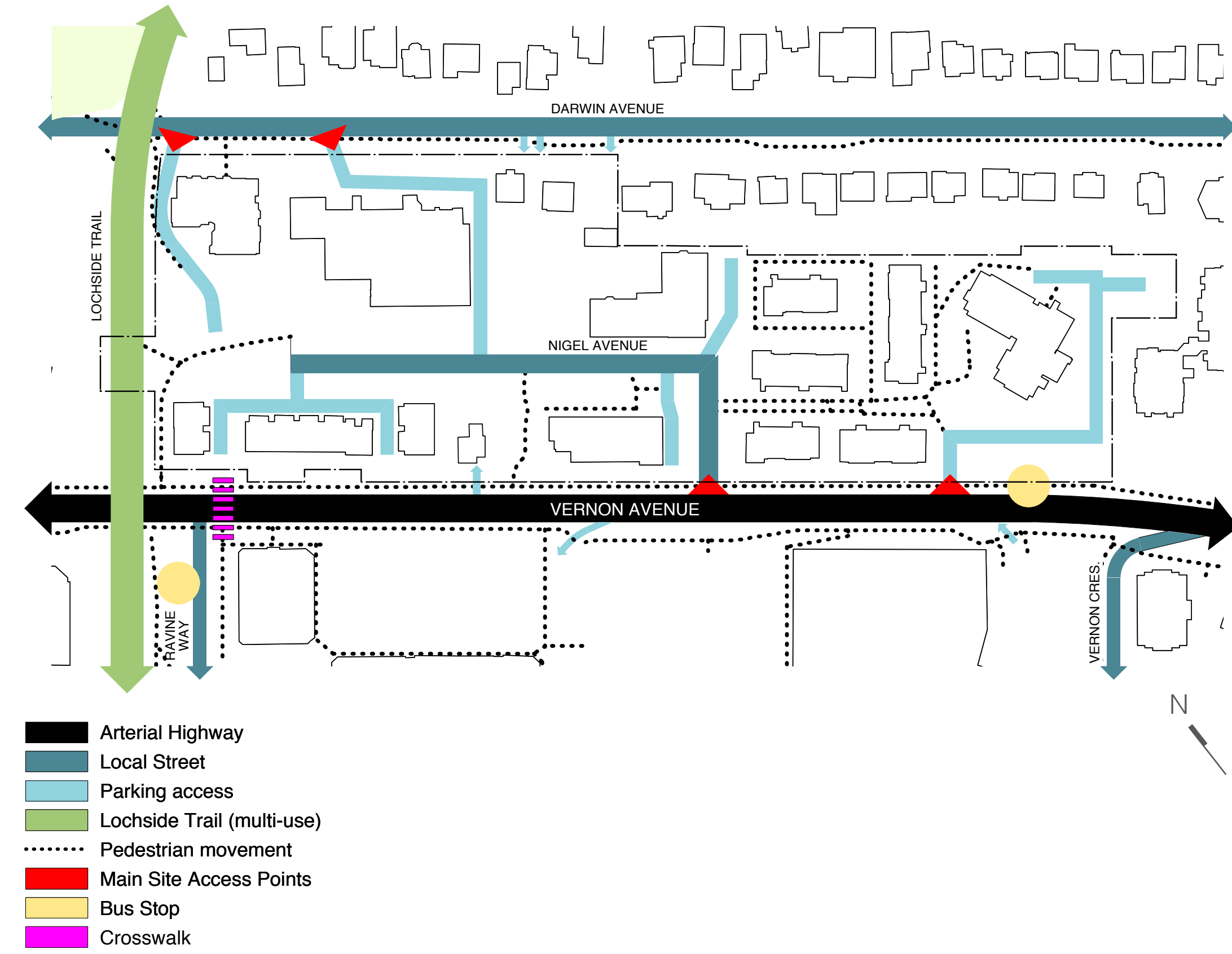

Improvements to be Considered in the Redevelopment of Nigel Valley



Looking to the south east along Vernon Avenue



Bicycle Lane in Use



Looking to the north west at the driveway to Saanich Hall



Access from Vernon

Topography



Site Opportunities

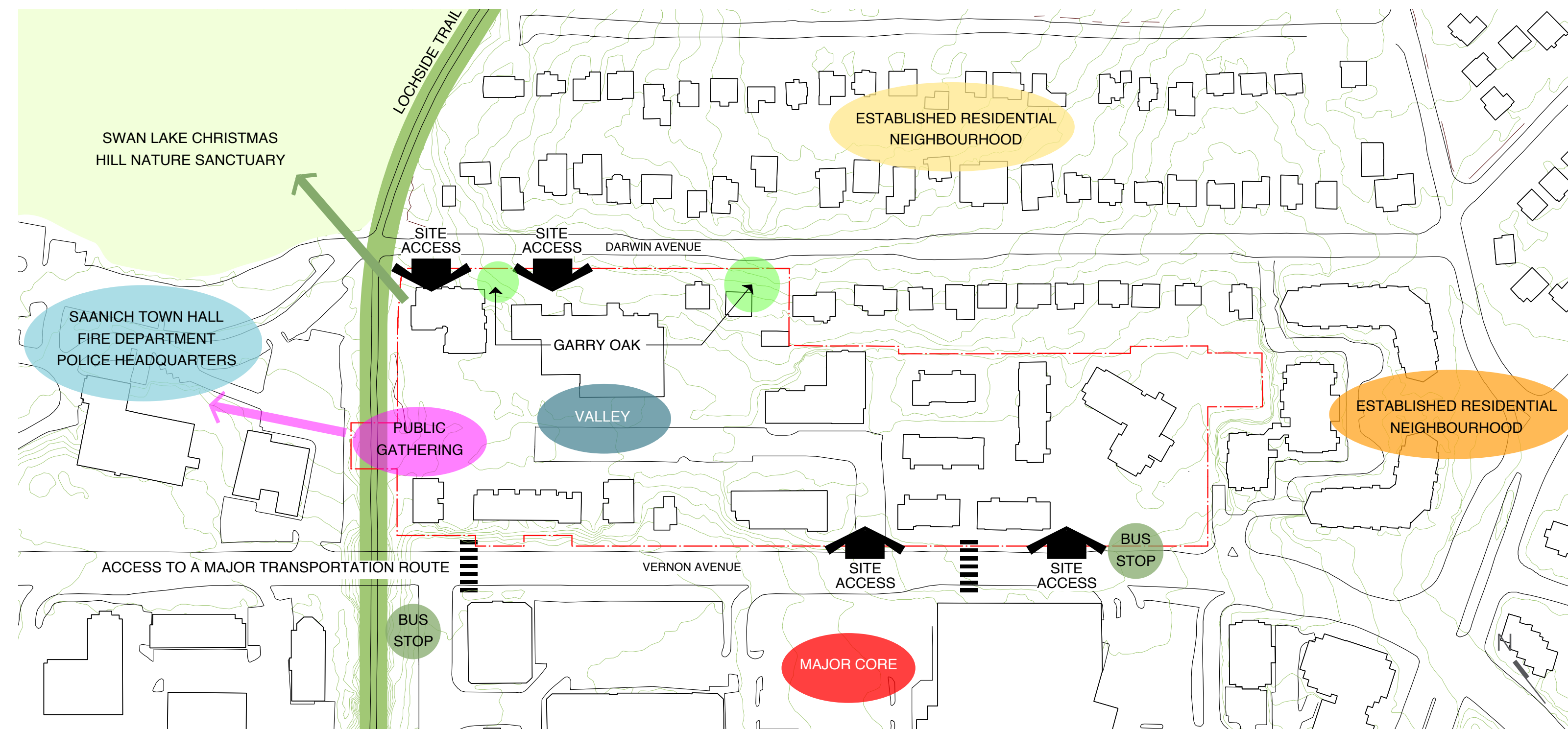

Existing Garry Oaks



Site Sections

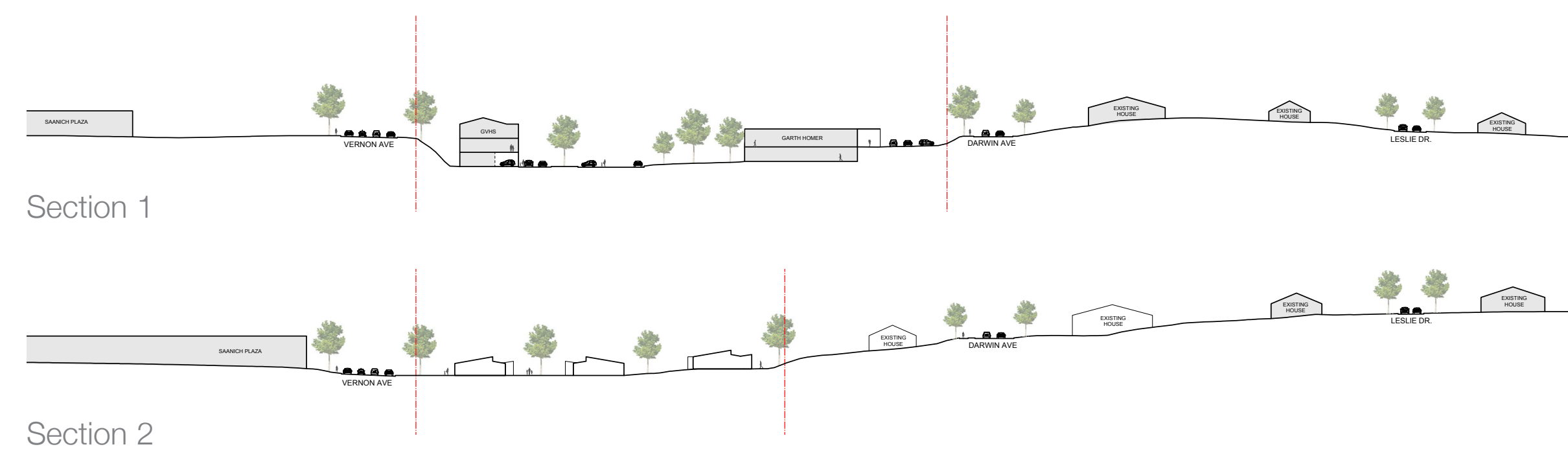

SITE ANALYSIS: CIRCULATION

- Arterial Highway
- Local Street
- Parking access
- Lochside Trail (multi-use)
- Pedestrian movement
- Main Site Access Points
- Bus Stop

